



**NEXXTECH™**  
Universal Remote

1519006





## Table of Contents

Setup .....	3
Battery Installation .....	3
Battery Saver .....	3
Code Saver .....	3
Code Setup .....	3
Button Functions .....	4
Code Entry .....	6
Direct Code Entry .....	6
Code Search .....	7
Using Your Remote .....	8
Code Identification .....	8
Sleep Function .....	9
Controlling Devices with Power On and Off ....	10
Controlling Combo Devices .....	10
VCR/DVD/DVR Punch-Through .....	10
Volume/Mute Control and Punch-Through .....	11
All Volume/Mute Control to any one Mode .....	11
Setting any Mode for its own Volume/Mute ....	12
Troubleshooting .....	13

Congratulations on your purchase of this Slider universal remote control. This universal remote is easy to set up and use. We think you'll enjoy the unique sliding case feature and compact design this remote offers. It controls up to four devices, including the most popular brands of TV, VCR, DVD, CBL, SAT equipment.

Note: Some functions from your original remote may not be controlled by this remote. Use the original remote, if available, to control such functions. Sometimes buttons other than described in these instructions may actually perform the function. For example, the CHAN and VOL buttons might be used to navigate through menu choices. We recommend you experiment with the remote to identify if such situations pertain to your equipment.

The Slider Remote is easy to use, easy to program, and it gives you total control—at the touch of your fingertips!



## Setup

### Battery Installation

1. On the back of the remote, slide the battery cover off.
2. Remove and discard the plastic tab under the two CR2032 Lithium batteries. When replacing batteries insert with the + side up.
3. Slide the battery cover back into place.

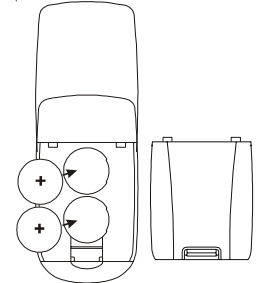

### Battery Saver

Your remote automatically turns off if the buttons are depressed more than 30 seconds. This will save your batteries should your remote get stuck in a place where the buttons remain depressed (e.g., between the sofa cushions).

### Code Saver

You will have up to 10 minutes to change the batteries in your remote without losing codes you have programmed. However, do not press any buttons until batteries are installed in the remote. If buttons are pressed without batteries in the remote, all codes will be lost.

### Setup

The **SETUP** button is used to setup the remote. You can either setup the remote using the code tables (on separate sheet), or you can search through the library of codes until you find a code that works for your product. Please refer to "Programming with Code Search" page 7 for more information on using the code search feature to learn how to search through the library of codes for your products. NOTE: You can store any kind of code under any mode (except TV). I.E. you can store a VCR code under the **SAT/CABLE** button, or a Cable code under the **DVD/VCR** button, etc. However, you can only store TV codes under the **TV** button.



## Button Functions

Some buttons on the remote might have functions that are referred to by different names on the device you are controlling. E.G. **LAST** may be called **RECALL**, or **DISPLAY** may be called **INFO**. These differences depend on the brand and model of your product. Also, this remote can only operate features that exist on your product. E.G., your product must have **LAST** ability for the **LAST** button to operate this feature.

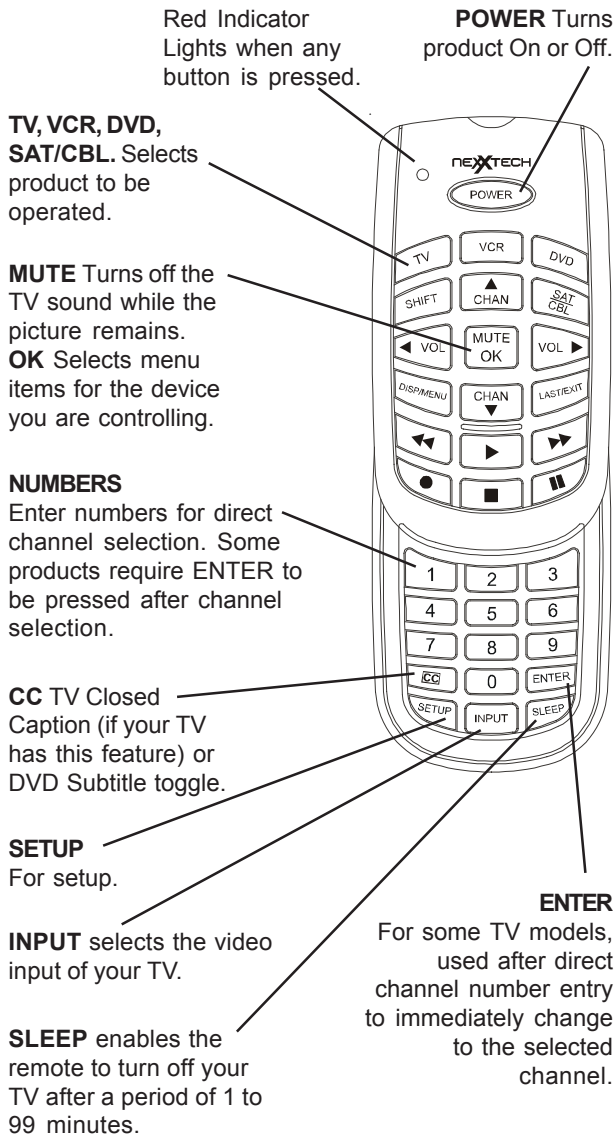

4

## Button Functions, cont.

The most commonly used buttons are accessible even with the remote "closed" as shown below. Just flip it open to gain access to less frequently used buttons.

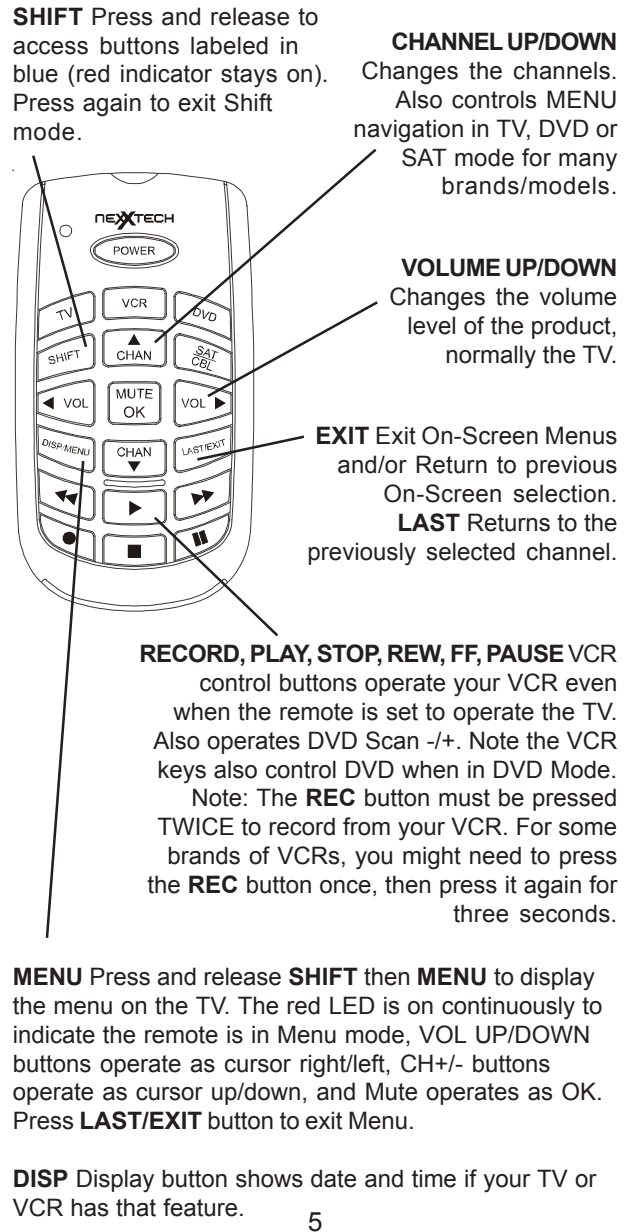

5



## Direct Code Entry

1. Press and hold the **SETUP** button until the red indicator stays on, then release the **SETUP** button.
2. Press and release the desired mode button (**TV**, **VCR**, etc.). The red indicator blinks, then stays lit.
3. Enter the 4 digit code from the code tables (on separate sheet). Note: after a valid code entry, the red indicator turns off. For an invalid code, the red indicator flashes.
4. With your device on, press **POWER**. If the device turns off, no further programming is required. Note: If some buttons do not operate your equipment, try one of the other codes for your brand.

Write your codes down here for easy reference later.

Device	Device stored	Code
TV	TV	
VCR		
DVD		
SAT/CBL		



## Code Search

If your device does not respond after you have tried all the codes for your brand, or if your brand is not listed, try searching for your code by following these steps.

1. Manually turn on the device (**TV**, **VCR**, etc.) to be controlled.
2. Press and hold the **SETUP** button until the red indicator stays on, then release the **SETUP** button.
3. Press and quickly release the desired mode button (**TV**, **VCR**, etc.). The red indicator blinks once, then stays on.
4. Press the **POWER** button repeatedly (up to 300 times) until the device to be controlled turns off. The red indicator blinks off with each button press.
5. Press and release **ENTER** to install the code.

Most users will store VCR codes under the **VCR** button, Cable codes under **CABLE**, etc. If (for example) you want to store a VCR code under **CABLE**, first follow the procedure for Direct Code Entry (page 6) and press **CABLE** in step 2 of Direct Code Entry, then enter ANY VCR code in step 3 of Direct Code Entry. Then follow the steps above for Code Search.





## Using Your Remote

### Code Identification

The Code Identification Feature allows you to identify the 4 digit library code stored under your device key. For example, if you want to find out what 4 digit code is stored under your TV device key, follow the six steps below:

1. Press and hold the **SETUP** button until the red indicator stays on. Release the **SETUP** button.
2. Press and release the desired mode button (**TV**, **VCR**, etc.). The red indicator blinks once, then stays lit.
3. Press and release the **SETUP** button. The red indicator blinks once and remains lit.
4. To find the first digit for the code stored under the mode key pressed in step 2, press each numeric key from **0-9** in turn. The number that causes the indicator light to blink is the first digit in your code.
5. To find the second and third digit, repeat step 4.
6. Repeat step 4 again to find the fourth digit. This time the red indicator turns off and stays off.



## Using Your Remote, cont.

### Sleep Function

The Sleep button enables the remote to turn off your TV after a period of 1 to 99 minutes as shown below. The remote must be in TV mode to set a Sleep Timer. This feature works even if your TV does not have a sleep feature.

1. Press and release the **TV** mode button.
2. Press and hold the Sleep button until the LED remains lit (about 2-3 seconds).
3. Release the Sleep button.
4. Press and release the numeric keys (01-99) for the time required. The LED will blink off to indicate button press acceptance.
5. TV Sleep Timer is set.
6. **Leave the Remote pointing towards the TV with an unobstructed path.**

To cancel the Sleep Timer, press and hold the Sleep button until the LED blinks, or press and release the Power key in TV mode.





## Using Your Remote, cont.

### Controlling Devices with Separate Power On and Off Buttons

Some GE, RCA and ProScan models require you to press the device button for more than one second to turn the device on and the **POWER** button to turn the device off.

### Controlling Combo Devices

Some Combo devices (e.g. TV/VCR, TV/DVD, DVD/VCR, etc.) will require you to set up two different Mode buttons to control both parts of the Combo device. For example, if you have a TV/DVD Combo, you might need to set up one code under the **TV** button to control the TV part AND a separate code (under any other Mode button) to control the DVD part.

### VCR/DVD Punch-Through

This remote allows the 6 VCR transport buttons (i.e. **PLAY**, **PAUSE**, **STOP**, **FF**, **REWIND**, and **REC**) to Punch-Through control from any Mode programmed with TV, SAT or Cable codes to the last **VCR**, or **DVD** programmed Mode you used. This feature will not operate if the programmed TV, SAT or Cable code has its own VCR transport button control e.g. a TV Combo, SAT/PVR, etc.



## Using Your Remote, cont.

### Volume/Mute Control and Punch-Through

This remote lets you select which device Mode controls your Volume/Mute buttons. The remote is initially set for all device Modes to use their own Volume/Mute control if present. If the programmed code has no Volume/Mute operation of its own then those buttons will punch-through control to the **TV** Mode device without the need to change to **TV** Mode.

**Any Mode chosen for Volume/Mute control MUST have its own Volume/Mute function or the Volume/Mute buttons will do nothing.**

### Setting ALL Volume/Mute Control to any one Mode

This routine can set all Modes to “punch-through” to any one chosen Mode for Volume/Mute button control without the need to change to that Mode.

1. Press and hold the **SETUP** button until the red indicator turns on, then release the button.
2. Press and hold the **MUTE** button until the red indicator blinks once and stays on, then release the button.
3. Press and release the desired Mode button (**TV**, **VCR**, etc.) for Volume/Mute control, the red indicator blinks once then stays on.
4. Press and release the **MUTE** button and the red indicator turns off. The red indicator will blink rapidly for three seconds if the Mode you have selected has no Volume/Mute control.

All other Modes will now punch-through to your chosen Mode for Volume/Mute control.





## Using Your Remote, cont.

### Setting any Mode to use its own Volume/Mute Control

This routine can set any Mode to use only its own Volume/Mute control. Note - If your chosen Mode has no Volume/Mute functions of its own then the Volume/Mute buttons will do nothing.

1. Press and hold the **SETUP** button until the red indicator turns on, then release the button.
2. Press and hold the **MUTE** button until the red indicator blinks once and stay on, then release the button.
3. Press and release the desired Mode button (**TV**, **VCR**, etc.), the red indicator blinks once then stays on.
4. Press and release the **VOLUME-** (Down) button, the red indicator blinks once then stays on.
5. Press and release the **MUTE** button and the red indicator turns off.

Your chosen Mode will now use its own Volume/Mute control.



## Troubleshooting

### Remote does not operate your product.

- Press the mode button of the product you want to control.
- Program the remote with a new code.
- Install new batteries. (You might have to reprogram your remote after installing new batteries.)
- Remote may not be compatible with your product.

### Remote does not operate some features of your product.

- Sometimes a particular code might operate some features but not all. Try programming remote with a new code.
- Remote may not be able to operate all features of your device or button names might be different than your product. Try other buttons on the remote. E.G. controlling the MENU cursor may be performed by CHAN or VOL buttons.

### Red Indicator blinks after you program a product code.

- Remote did not accept the code.
- Try to program the code again or try a different code.





## LIMITED WARRANTY

### Who is Providing This Warranty?

- Orbyx Electronics, LLC ("Orbyx"), as the distributor of this Nexxtech™ product (your "Product").

### What Does This Warranty Cover?

- This warranty covers defects in materials or workmanship in your Product under normal use and conditions.

### What is the Period of Coverage?

- This warranty covers your Product for 90 days from the original purchase date.

### Who Is Covered?

- This warranty covers the original consumer purchaser. Coverage terminates if you sell or otherwise transfer your Product.

### What Will We Do To Correct Problems?

- We will repair your Product or replace your Product with a new or reconditioned equivalent product, at our option.

### How Do You Get Service?

- Call Orbyx TOLL FREE at 1-866-363-3059 for instructions for obtaining warranty service from Orbyx's authorized service providers.
- Or, return your Product directly to the retail store from which you purchased the Product.
- When you obtain service for your Product, you must provide a purchase receipt (or other proof of the original purchase date) and a description of the defect(s).

### What Does This Warranty Not Cover?

- This warranty DOES NOT COVER:
  - damage due to misuse, abuse, alteration, unauthorized repair, or accident (such as improper electrical current);
  - damage due to "acts of God" (such as lightning) or other contingencies beyond our control;
  - cosmetic damage;
  - externally generated static, signal reception or antenna problems not caused by your Product; or batteries.
- This warranty also DOES NOT COVER, and in no case will we be liable for, any incidental damages (such as transportation costs to and from an authorized service provider, or loss of time) or consequential damages (such as costs of repairing or replacing other property which is damaged, including tapes, discs, speakers not included with your Product or other accessories, or external electrical systems) resulting from the use of your Product. Some states do not allow the exclusion or limitation of incidental or consequential damages, so the above limitation or exclusion may not apply to you.
- Defacing the serial number, or using your Product for commercial or institutional purposes, voids this warranty.

### Are There Other Warranties?

- There are no express warranties other than those expressed herein. Neither the sales personnel nor any other person is authorized to make any other warranties or to extend the duration of any warranties.
- ANY IMPLIED WARRANTIES, INCLUDING ANY IMPLIED WARRANTY OF MERCHANTABILITY (AN UNWRITTEN WARRANTY THAT A PRODUCT IS FIT FOR ORDINARY USE), ARE LIMITED TO 90 DAYS. Some states do not allow limitations on how long an implied warranty lasts, so the above limitation may not apply to you.

### How Does State Law Apply?

- This warranty gives you specific legal rights, and you may also have other rights which vary from state to state.



## LIMITED WARRANTY

### ORBYX ELECTRONICS WARRANTY

ORBYX Electronics warrants that this product will be free from defects in materials and workmanship for a period of ninety (90) days from the date of purchase. Within this period, simply take the product and your proof of purchase to any ORBYX Electronics store or dealer and the product will be repaired without charge for parts and labour. ORBYX Electronics reserves the right to charge for transportation. Any product which has been subject to misuse or accidental damage is excluded from this warranty.

This warranty is only applicable to a product purchased through ORBYX Electronics' company owned stores and dealers and to a product that is presented for repair in a country where ORBYX Electronics offers the product for sale. While this warranty does not confer any legal rights other than those set out above, you may have additional statutory rights which will vary under the laws of the various countries, states, province and other governmental entities in which ORBYX Electronics operates. This warranty is subject to all statutory rights you may have in the country of purchase.

Distributed exclusively in the U.S. by  
Orbyx Electronics, LLC  
501 South Cheryl Lane,  
Walnut, CA 91789

Imported in Canada for/Importé au Canada pour  
Orbyx Electronics,  
Concord, Canada, L4K 4M3

Manufactured in China

For product support please contact [www.orbyxelectronics.com](http://www.orbyxelectronics.com)  
or 1-866-363-3059



Limited Warranty/Garantie Limitée  
U.S.A & Canada

© 2005 ORBYX Electronics. All Rights Reserved.

